

## **STAFF REPORT**

Town Council, March 23, 2016

### **Stephen Douglas Annexation 15-A-28 (PL16-070a)**

Conduct public hearing and consider action for proposed annexation ordinance and adoption date

From: Jeff Ulma, Planning Director

Prepared by: Wayne Nicholas, Planning Manager

Approved by: Mike Bajorek, Interim Town Manager

Approved by: Russ Overton, Assistant Town Manager

**Speaker:** Wayne Nicholas

**Executive Summary:** Request by the property owner(s) to annex property located at 211 Brookridge Dr. (3300 feet NW of Penny Road and Brookridge Drive intersection). Associated Case(s): 16-SP-003 (Crown Castle- Douglas)

**Proposed Council Action:** Council may take action.

**Annexation Petition Number:** 15-A-28

**Wake County Parcel Number:** 0761776935 Portion

**Real ID Number:** 0059005 Portion

**Petition Date:** 12/28/2015

### **ZONING & PROPOSED USE:**

**Current Zoning:** Residential R-40

**Acreage:** 4.20 plus 0.00 adjacent right of way = 4.20 total deeded acres

**Contiguous to Primary Corporate Limits:** Yes

**% Contiguity (excluding satellite town limits):** 50%

**Existing Use:** Vacant

**Proposed Use:** Telecommunications Tower

### **UTILITIES:**

**Water:** 120 feet W

**Sewer:** On Site

### **DISTRICTS & TAX VALUE:**

**Fire District:** Fairview Fire District

**Voting District:** C

**Tax Value:** 0

### **2/25/2016 MEETING:**

**Town Council – Certificate of Sufficiency and Resolution Ordering Public Hearing**

### **STAFF RECOMMENDATION:**

Forward to public hearing on 3/23/2016

**Action:** Forwarded to public hearing

### **3/23/2016 MEETING:**

**Town Council – Public Hearing**

### **STAFF RECOMMENDATION:**

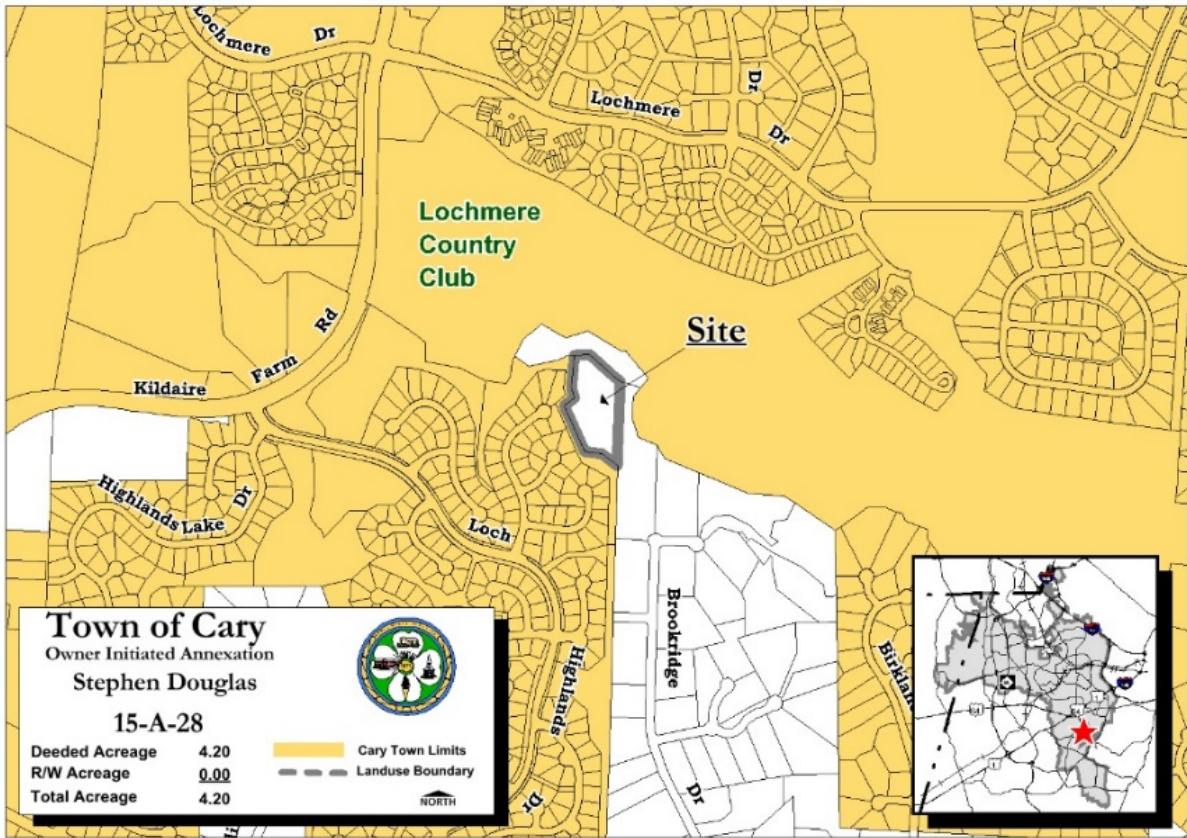

Hold public hearing and consider adoption of ordinance with an effective date determined by council action

**Action:** Public hearing held; Adopted with effective date **3/23/2016**



**Town of Cary**  
 Owner Initiated Annexation  
 Stephen Douglas

**15-A-28**

Deeded Acreage	4.20		Cary Town Limits
R/W Acreage	9.00		Landuse Boundary
Total Acreage	4.20		

NORTH