

STANDARD CURB TYPE

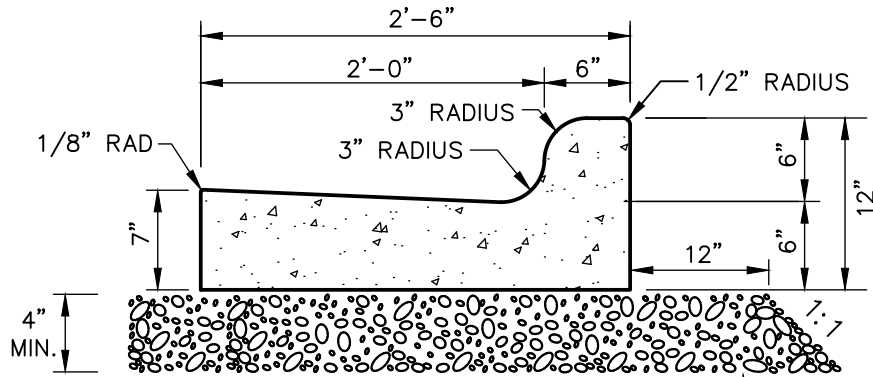

STANDARD 30" CURB & GUTTER  
SIDE VIEW

AGGREGATE BASE COURSE (A.B.C.)  
UNDER THE CURB & GUTTER

JOINT FILLER: MAINTAIN 50-FT MAX. BETWEEN  
JOINTS OR AT ALL RIGID OBJECTS

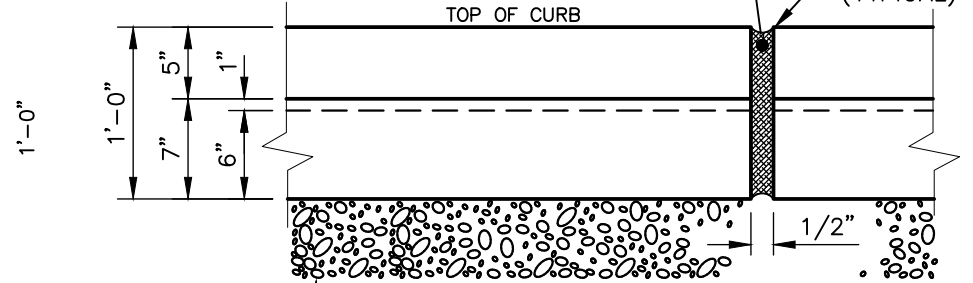

FRONT VIEW  
TRANSVERSE EXPANSION JOINT

ALTERNATE CURB TYPES

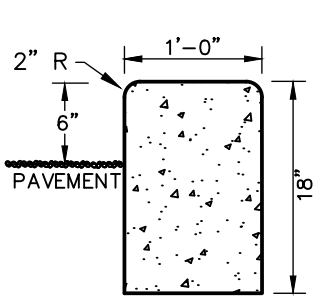

12 INCH CURB  
SIDE VIEW

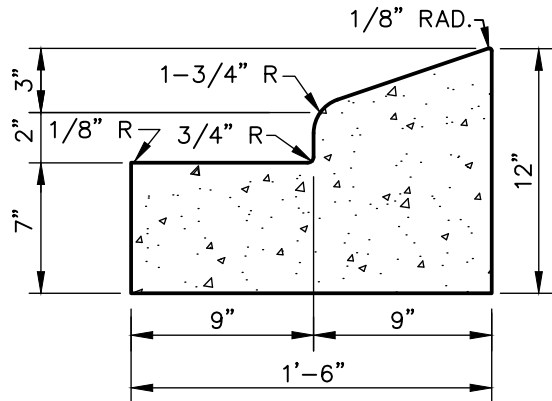

MEDIAN CURB & GUTTER  
SIDE VIEW

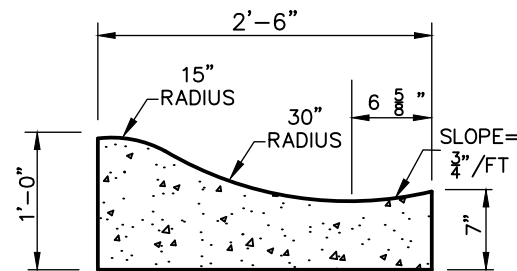

ROLLED CURB  
SIDE VIEW

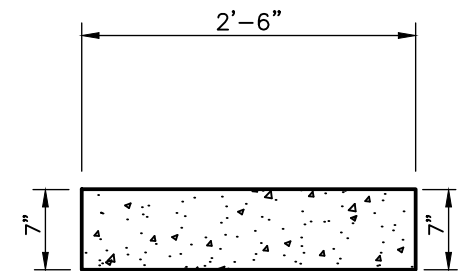

CONCRETE BORDER CURB  
SIDE VIEW

NOTES:

1. CONCRETE SHALL BE 3,000 P.S.I.
2. CONTRACTION JOINTS SHALL BE SPACED AT 10 FOOT INTERVALS. (A 15 FOOT SPACING WILL BE ALLOWED WHEN A MACHINE IS USED)
3. FINISH ALL CONCRETE WITH CURING COMPOUND.
4. REFER TO NCDOT DET. 846.01 FOR CURB & GUTTER SUPERELEVATION RATES.

CONCRETE CURB AND GUTTER TYPES

DETAIL No.

3100.01



EFFECTIVE: 07/01/21