

MEDIAN DIVIDED ROAD

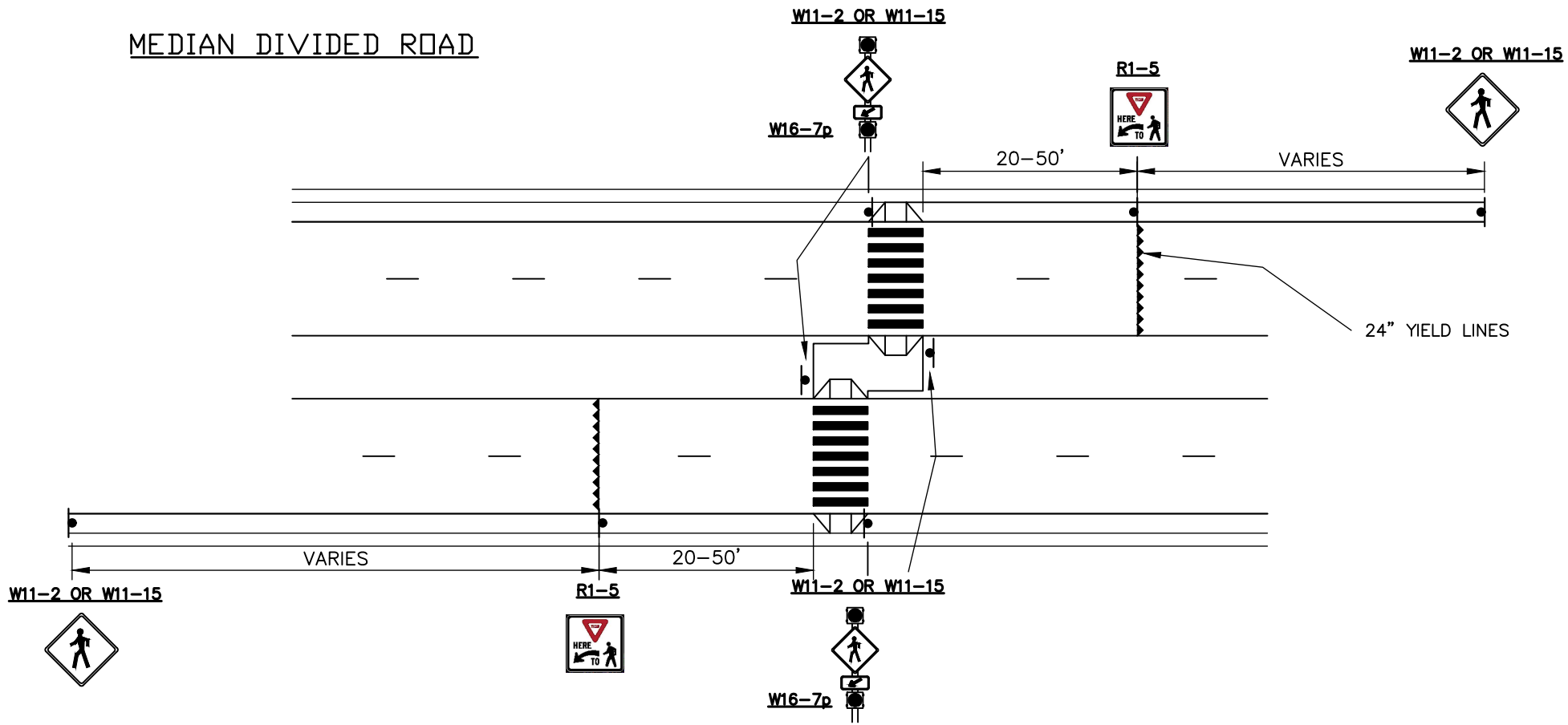

NOTES:

1. USE W11-15 FOR GREENWAY CROSSING, USE W11-2 FOR OTHER CROSSINGS
2. SOLAR POWERED PEDESTRIAN BEACON
3. BLACK POWDER COAT ON ALL MATERIALS
4. MOUNT ON 4" PELCO PEDESTAL OR EQUIVALENT
5. ALL SIGNS ARE FLUORESCENT YELLOW-GREEN



EFFECTIVE: 07/01/21

PEDESTRIAN BEACON LAYOUT (MEDIAN DIVIDED)

DETAIL No.

3500.10