

MEDIAN DIVIDED ROAD

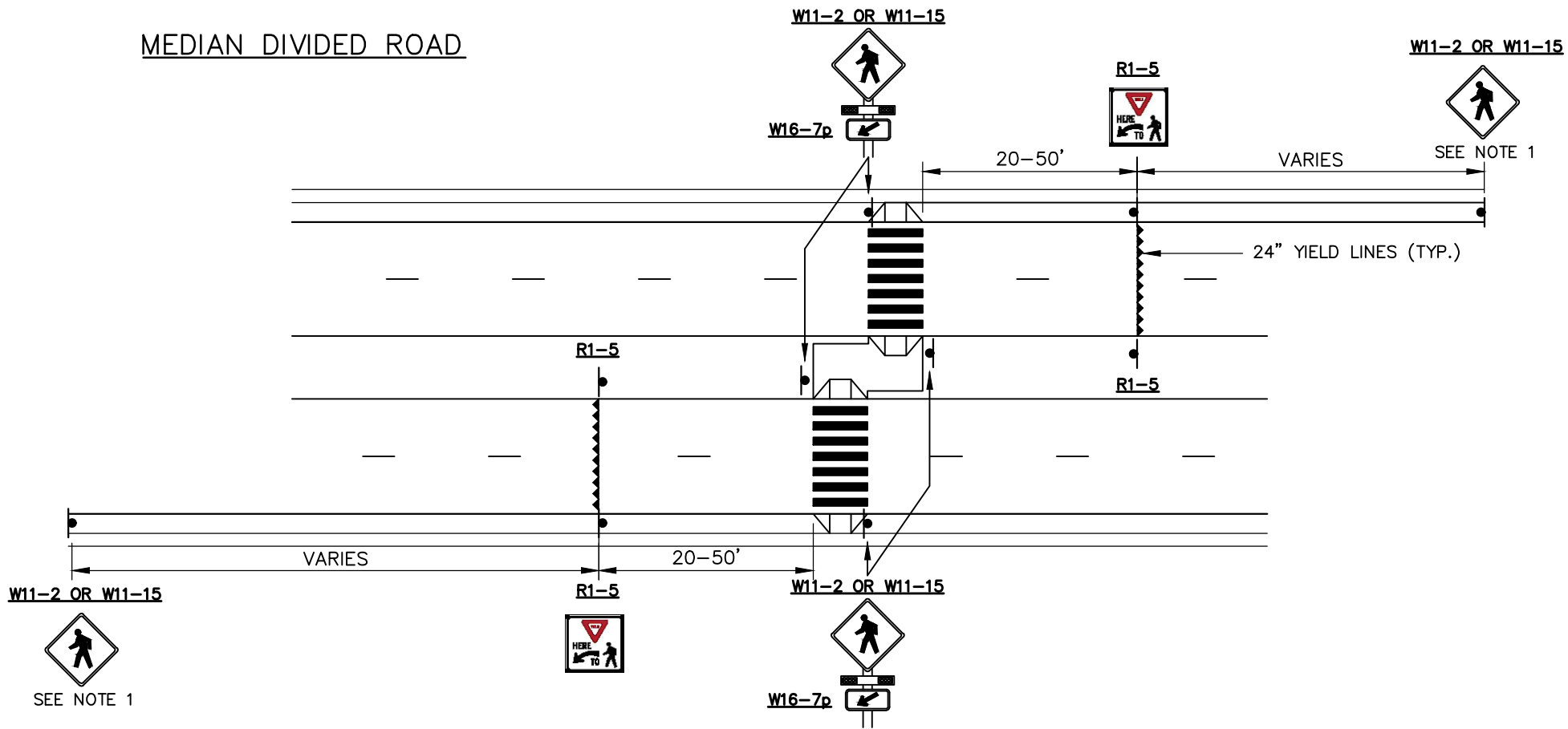

**NOTES:**

1. BEACONS MAY BE PLACED ON ADVANCE SIGN ASSEMBLIES. IF USED, THE BEACONS SHALL BE RADIO CONNECTED TO THE UNITS AT THE CROSSWALK
2. USE W11-15 FOR GREENWAY CROSSING, USE W11-2 FOR OTHER CROSSINGS
3. FLUORESCENT YELLOW-GREEN FOR W11-2 AND W11-15 AND W16-7P
4. BLACK POWDER COAT ON ALL MATERIALS



**RECTANGULAR RAPID FLASHING BEACON LAYOUT  
(MEDIAN DIVIDED)**

DETAIL No.

3500.05

EFFECTIVE: 07/01/22