

FRONT VIEW

NOTES:

1. USE SILT FENCE ONLY WHEN DRAINAGE AREA DOES NOT EXCEED 1/4 ACRE PER 100 ft. OF FENCE AND NEVER IN AREAS OF CONCENTRATED FLOW.
2. OVERLAP 12 INCHES WHEN SPlicing FABRIC.
3. FOR REPAIR OF SILT FENCE FAILURES USE DETAIL 4000.23.

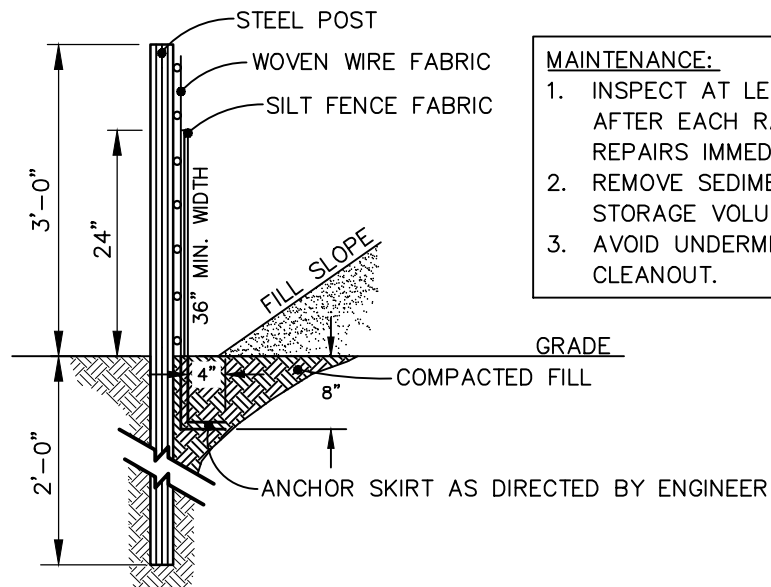

SIDE VIEW

MAINTENANCE:

1. INSPECT AT LEAST ONCE A WEEK AND AFTER EACH RAINFALL. MAKE REQUIRED REPAIRS IMMEDIATELY.
2. REMOVE SEDIMENT TO PROVIDE ADEQUATE STORAGE VOLUME FOR NEXT RAIN.
3. AVOID UNDERMINING THE FENCE DURING CLEANOUT.

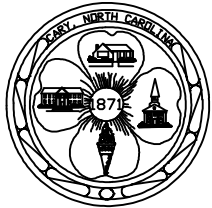

EFFECTIVE: 07/01/23

STANDARD TEMPORARY SILT FENCE

DETAIL No.

4000.01